

Dimple Dash

20502 rA

Wall Sconce
Low Voltage Input

Note: External power supply may be required.

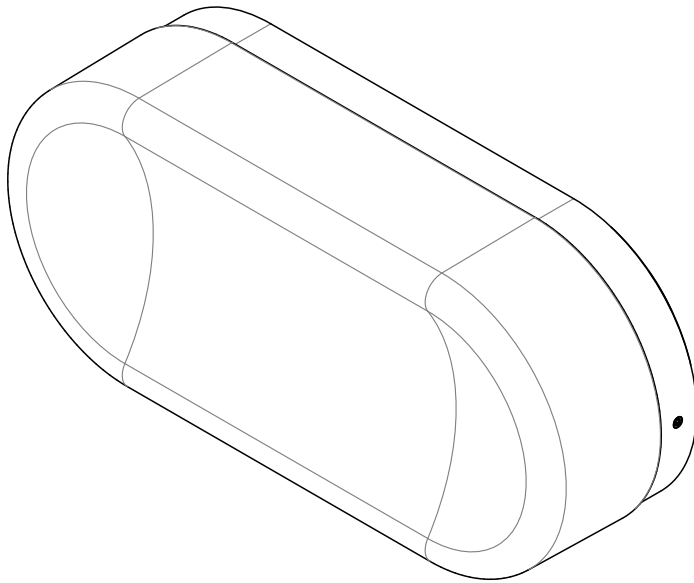

CAUTION:

Before starting, turn off power
at main circuit panel.

ADVERTENCIA:

Antes de comenzar la instalación,
apague la corriente en el tablero
principal.

ATTENTION:

Coupez l'alimentation avant de
procéder à l'installation.



Calling for backup? Scan above
to contact our team.

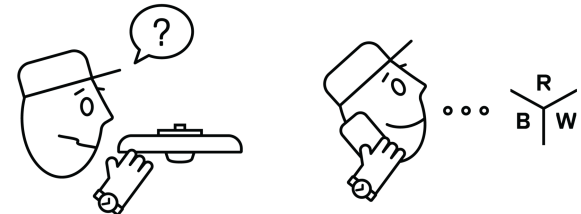

www.RBW.com
+1 212 388 0399
support@RBW.com
© 2025, RBW Studio LLC

What's Included: Part Configurations May Vary

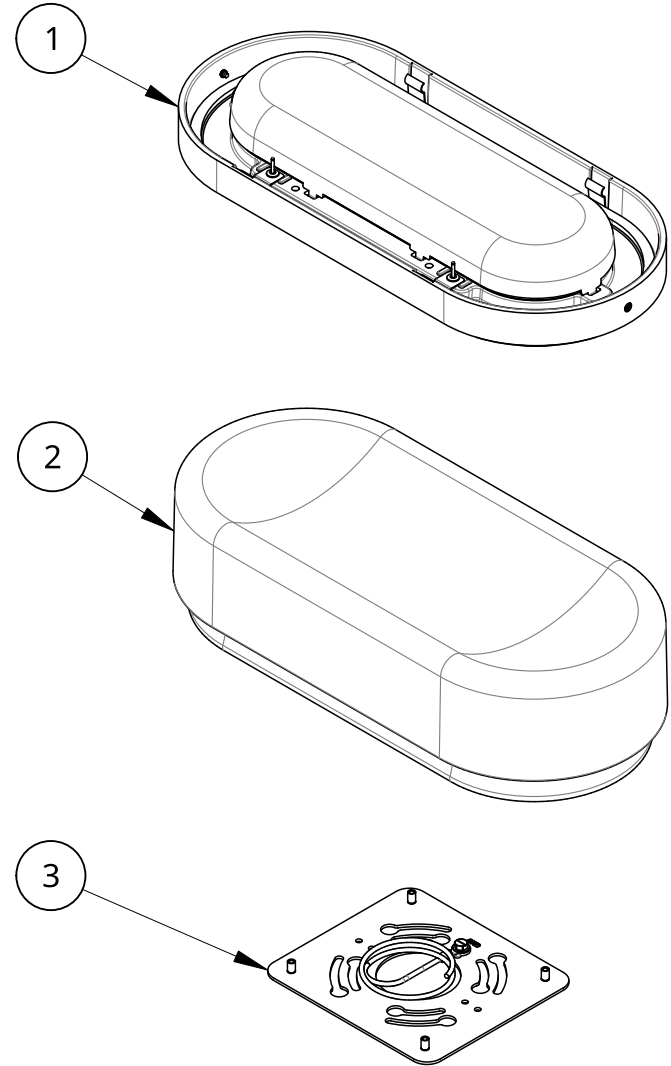

Item	Qty	Description
1	1	Assembly: Dimple Dash. Backplate
2	1	Dimple Dash. Glass Shade
3	3	Assembly: Dimple Dash. Wall Mount Plate w/ Mounting Screws

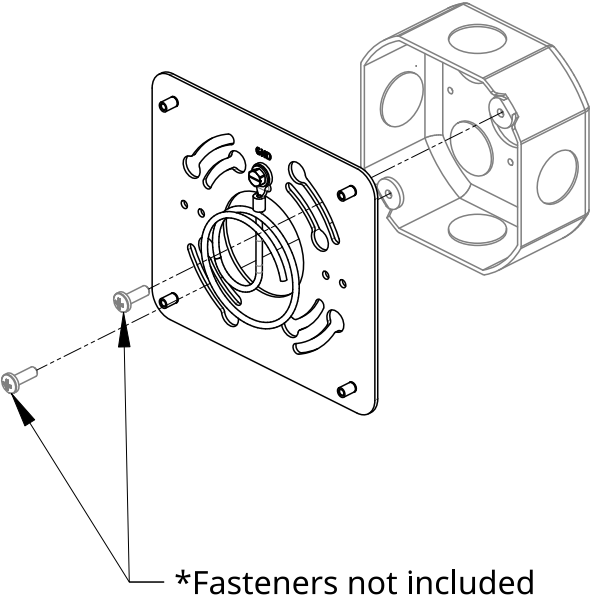

Installation - Wall Mount Plate

1. Connect Ground Strap according to electrical code.
2. Fasten Wall Mount Plate to Junction Box, ensuring edge of plate is level.

NOTE: This luminaire can be installed horizontally or vertically depending on the mounting orientation of the Wall Mount Plate.

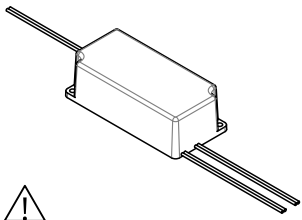

⚠
Driver dimensions and location may vary, consult your order confirmation for details.

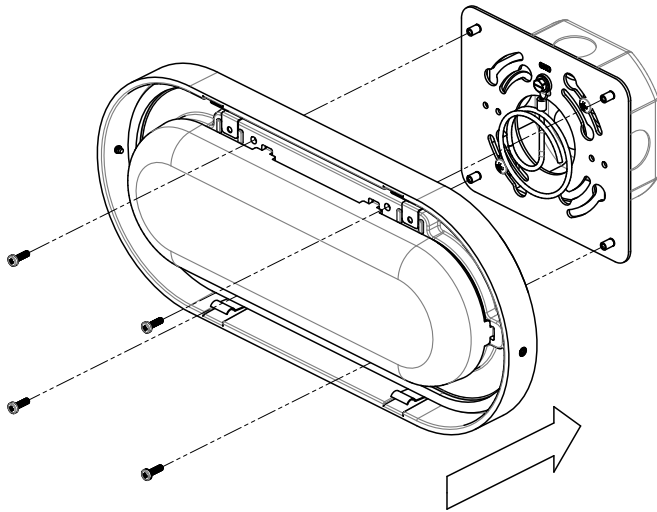

Installation - Backplate

3. Connect Red (+) and Black (-) Sconce wires to low voltage leads from externally located driver.
4. Fix Backplate to Wall Mount Plate with (4) provided fasteners.

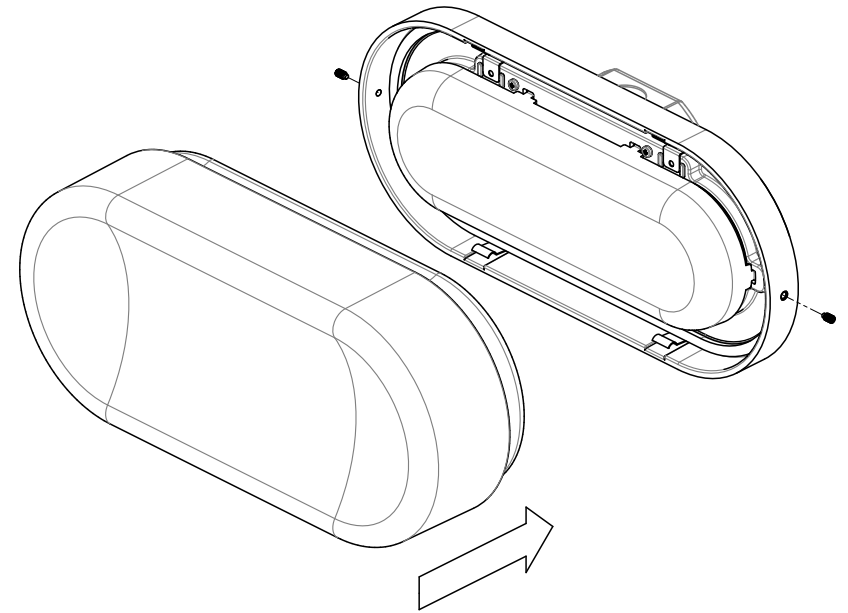

Installation - Glass Shade

5. Snap Glass Shade into spring clips of Backplate, maintaining positive pressure on shade.
6. While pressing firmly on the Glass Shade to compress the inner gasket, tighten set screws at both ends of the Backplate to secure the glass.
7. Congratulations! End of guide.